

APS LTD
GUN SPECIALIST 1993

www.aps-concept.com

HANDLING & INSTRUCTION MANUAL (For All PR Model Use) ASR SERIES ELECTRIC BLOW BACK GUN



HOT UP SYSTEM

WARNING
This gun is not intended for unsupervised use by any persons under the age of 18 years. Always read the instructions carefully before operation.



2 LAYOUT STRUCTURE

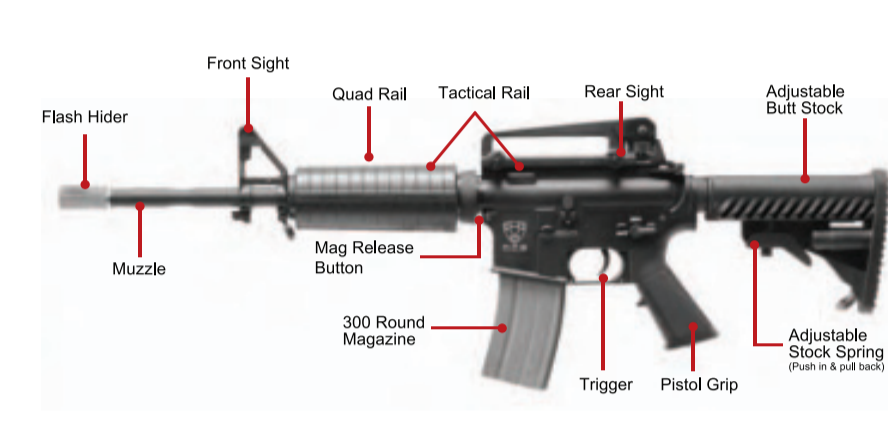

3 SPECIFICATION

	Barrel Caliber	Barrel Capacity	Pellet	Initial Pellet Speed
PR301	6.08mm	300	6mm BB	105-130m/s
PR302	6.08mm	300	6mm BB	
PR303	6.08mm	300	6mm BB	
PR304	6.08mm	300	6mm BB	
PR305	6.08mm	300	6mm BB	

1 WARNING (RESTRICTED TO USER UNDER AGE OF 18 YEARS)

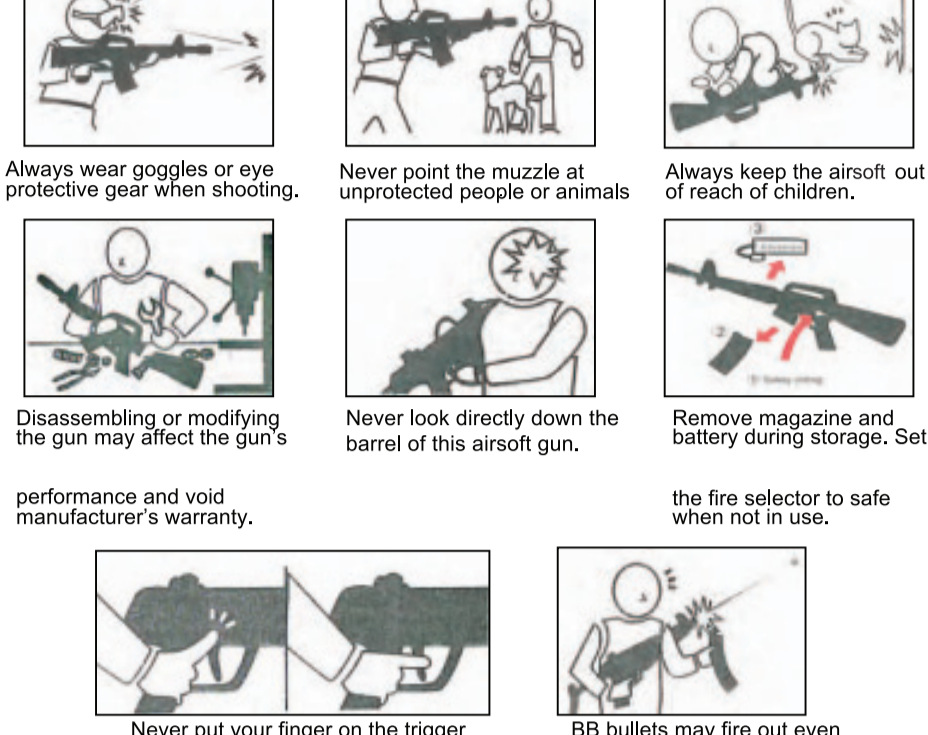

WARNING This sport gun was developed for enjoying sport shooting only. As the Airsoft Gun has the potential risk of serious injury such as blindness and damage to property, please read all instructions and warnings in this manual before using this airsoft gun.

- This airsoft is capable of shooting 6mm diameter BB. Operate the airsoft with caution and pay attention to safety.
- During a game, always put your goggles on full to wear eye protection gear in the worst case will cause blindness.
- Do not operate the gun to people who do not participate in the game but look with the extended dangerous firing zone.
- Never shoot any items that subject to break (glass, lens, car, gas bomb, etc).
- Never insert other items rather than BB into the magazine or gun barrel.
- The gun must not be operated after drinking to avoid possible danger.
- Avoid during the gun at place subject to trip or fall. Always there at place out of children reach.
- Malfunction of motor or battery will occur if the gun was immersed by water. Stop operating the gun, remove the battery and consult our service department immediately.
- No major punishment if you are shooting for a practical joke. Positive playing manner & enjoy healthy sport shooting is essential.
- Select a safe place for operating the airsoft, avoid places where people and cars pass across or third persons are around.
- Always use the gun in a case or bag when you are carrying it. Avoid giving rise to public panic.
- BB bullets may fire out even the magazine is removed. Direct the muzzle towards a safe area. Pull the trigger to confirm no bullets remain in the gun. Then attach the protective plug to the muzzle when unused.
- Remove the magazine and battery from the gun when unused.

17 TROUBLESHOOTING GUIDE

Status	Cause	Action
No operation at all	Fire selector is set to SAFE Battery is not charged Battery connector is disconnected or reversed Fuse is blown Poor motor electrical connection Expired motor life	Set the fire selector to semi or full-auto Fully charge the battery Connect the connector correctly Replace the fuse Check and repair the motor Replace a new motor
Although the motor is running, no BB's fire	Magazine is not fully placed into the receiver Bullets are clogged in Hop up system or barrel Faulty gear Levers may be broken	Load the magazine into receiver and turn the gear wheel. If it still doesn't work, contact customer service and ask for assistance. Use the cleaning rod to remove clogged BB's Please contact customer service and ask for assistance
Full-auto not functioning	Insufficient battery power Faulty BB's feed from magazine	Charge the battery Using the cleaning rod to remove clogged BB's
Semi-auto not functioning	Deviation in gear timing Insufficient battery power Faulty BB's feed from magazine	Fix 5-6 rounds in full auto then switch back to semi auto again Change the battery Use the cleaning rod to remove clogged BB's
BB's roll out from barrel	Hop up or barrel damaged Faulty or poor quality of BB Plastic or O-ring of BB	Please contact customer service and ask for assistance Use higher quality BB
Shooting distance greatly reduced	Hop-up or barrel damaged Distorted piston spring Gear problem caused by excessive dry fire Faulty BB's	Please contact customer service and ask for assistance
Loud operation noise	Damaged Gears Problem caused by engagement between the motor and gears	Please contact customer service and ask for assistance Do not turn the engagement between the motor and gears by yourself, contact customer service and ask for assistance
Gun has been immersed by water	Stop Operation immediately and disconnect the battery. Wipe off any excess water from inside the body and from the battery. When ACO is completely dry, wait 48h for the operation or signs of malfunction is asserted, please contact customer service and ask for assistance.	

16 FLIP UP SIGHT (FRONT)



4 FIRING OPERATION

WARNING Keep the airsoft gun in the "SAFE" position until you are actually ready to shoot. Then turn the safety to the other two positions.

Note: This airsoft gun fires in semi or full auto-mode. Full auto means it continues to fire plastic BB's as long as you hold the trigger. Semi-auto means you will have to pull the trigger to fire a shot.

Safe Semi Auto Full Auto



Selecting Firing Mode

- Locate the safety on the left side of the receiver.
- Turn the lever to "SEMI" for semi-auto mode.
- Turn the lever to "AUTO" for full-auto mode.
- The airsoft gun is off "SAFE" and ready to fire when pointing to either "SEMI" or "AUTO".
- Once in desired mode, point at predetermined target and pull trigger.

CAUTION

- Confirm your firing area is safe before firing.
- There are possibilities that no BB comes out after pulling the trigger. This may happen when new magazine is inserted. Switch to Full Auto and fire 5-10 shots to solve the problem.
- Change the battery if the firing rate becomes slow.
- Give the Airsoft Gun a rest of 5-10 minutes after firing 220 rounds in order to ensure long service lives of the motor and battery.
- If bullets are clogged, stop firing and remove the clogged bullets immediately.
- Service the Airsoft Gun with silicon oil as daily maintenance.
- Hop up may be unstable for first 200-300 rounds after silicon oil is used, this is normal operation of the gun.

5 FUSE DEVICE

- Maximum voltage allowed is 15V and Ampere is 20A below. Fuse is required to protect against the motor and gear box.
- During installation, make sure the electrical conductor is insulated.
- Replacing the fuse device in a ventilated area and avoid direct contact with human body.
- If there is a mal-operation heating in the gear box, for example heating in the gear case, stop pressing the trigger and cut off the power immediately. Check the fuse and fix the gear box before using again to avoid damage of the electronic component.

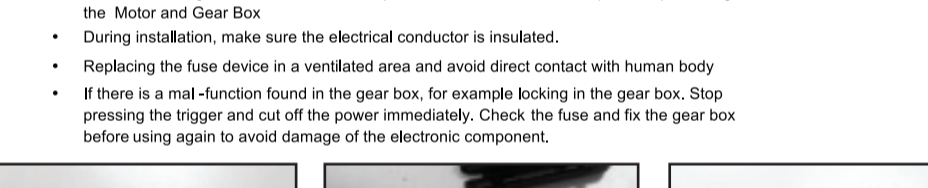

6 INSTALL BATTERY

This airsoft gun will not function properly without a fully charged battery. Charge the battery 6 hours prior to initial use. Do not overcharge the battery. Unplug the battery charger when not in use.

WARNING Changes or modifications to this unit not expressly approved by the party responsible for compliance could void the user's authority to operate the equipment.

NOTE: This equipment has been tested and found to comply with the limits for a Class B digital device, pursuant to Part 15 of the FCC Rules. These limits are designed to provide reasonable protection against harmful interference in a residential installation. This equipment generates, uses and can radiate radio frequency energy and, if not installed and used in accordance with the instructions, may cause harmful interference to radio communications. However, there is no guarantee that interference will not occur in a particular installation. If this equipment does cause harmful interference to radio or television reception, which can be determined by turning the equipment off and on, the user is encouraged to try to correct the interference by one or more of the following measures:

- Reorient or relocate the receiving antenna.
- Increase the separation between the equipment and receiver.
- Connect the equipment into an outlet on a circuit different from that to which the receiver is connected.
- Consult the dealer or an experienced radio/TV technician for help.

CAUTION Use caution when handling and using the battery or charger to prevent the risk of electric shock.

To prolong battery life and maintain the best shooting performance rest the gun for 10 minutes after shooting. For optimum performance completely use up the battery before recharging. **DO NOT OVERCHARGE THE BATTERY. UNPLUG THE BATTERY CHARGER WHEN NOT IN USE.**



Loading the Battery

- Make sure the airsoft gun is in "SAFE", UNLOADED, and pointed in a SAFE DIRECTION.
- Slide the delta ring back and remove the bottom of the quad rail.
- Insert the battery in the quad rail as shown and connect the battery to the gun.
- Place the connector in the space around the barrel.
- Place the front end of the quad rail back into position, being sure to hold the battery in place.
- Slide the delta ring back and lock the delta ring into position.

14 RHINO SIGHT

Two way rear sight (small hole for aiming long range and big hole for aiming close range)

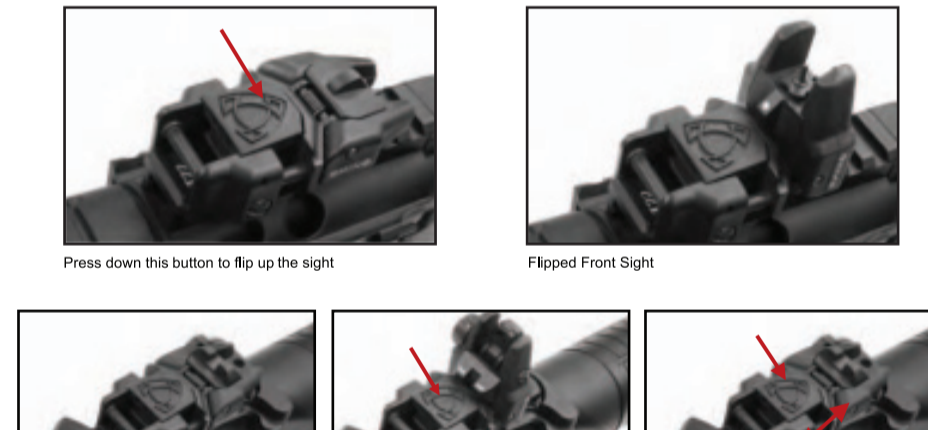

15 FLIP UP DINOSAURS SIGHT (FRONT)



12 BASIC MAINTENANCE (REMOVING JAMS & BARREL CLEANING)



Cleaning Jammed BBs

- Never lock down the end of the barrel to see if a jam has been cleared.
- Make sure the airsoft gun is on "SAFE" and pointed in a SAFE DIRECTION.
- Remove the magazine.
- Make sure to return the hop-up wheel to the NORMAL position.
- Insert tapered end of the cleaning rod into the muzzle with the angle toward the breech (where the magazine connects).
- CAREFULLY and slowly apply increasing pressure until you push the BB out of the breech.
- Insert the magazine and test gun in a predetermined SAFE DIRECTION.

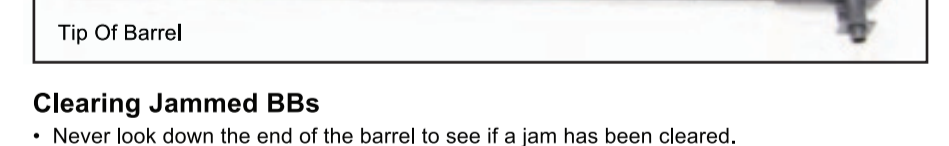

Cleaning the Muzzle

- Maintenance is needed when BB speed becomes slow.
- Never lock down the end of the barrel to see if debris has been cleared.
- Make sure the airsoft gun is on "SAFE" and pointed in a SAFE DIRECTION.
- Remove the magazine.
- Make sure to return the hop up wheel to the NORMAL position.
- Cut a strip of cotton cloth the width of the eyellet hole and rotate the cloth around the muzzle.
- Insert the cleaning side of the rod into the barrel of the gun while slowly twisting down the muzzle.

13 DISASSEMBLING THE GUN



7 IRON SIGHT ADJUSTMENT (REAR)



Adjust the rear sight by turning the dial up wheel forward will make the sight go up. Turning the dial up wheel backward will make the sight go down.

8 FILLING THE MAGAZINE

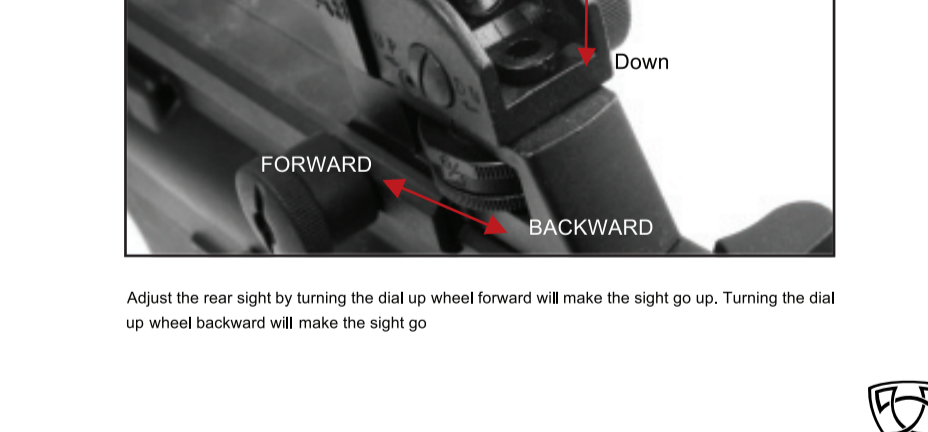

9 EXTEND THE BUTT STOCK

The butt stock is extendable by pushing up the lock underneath of the stock. Slide the butt stock backward by holding up the lock. There are 6 position extendable for user choice.

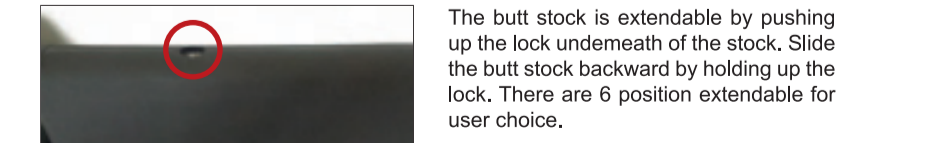

10 INSTALL BATTERY (CRANE STOCK)



11 HOP UP ADJUSTMENTS

CAUTION

- The best position is where the BB's fly horizontally and the longest flying distance is obtained.
- Turning excessively adversely affects the trajectory. Stop turning the dial when BB's fly horizontally.
- Moving the lever to much towards HOP will cause bullets to clog. Firing the gun with clogged BB's will damage the piston and gears.
- If the hop-up is adjusted excessively and causing the BB's to clog, stop operating the gun immediately. Return the lever to NORMAL and remove the clogged BB's (see section 7).
- Black Ops™ will not be held responsible for any damages or accidents caused by incorrect operation, disassembly, or modification of the airsoft gun.

Using the Hop-Up Mode

- This airsoft gun is manufactured with an adjustable hop-up system.
- The purpose of this system is to change the spin on the BB as it leaves the muzzle, allowing you to adapt your shot for different distances.
- Pull out and hold the charging handle to open the ejection port cover.
- Turn the hop-up adjustment dial clockwise for more spin, counterclockwise for less spin.

